

Direction-Plus Volkswagen Amarok V6 Fuel Manager Post-Filter Installation Guide

This document is to be used as a guide for the installation of the **Direction-Plus Fuel Manager Post-filter kit (PF643DPK)** to a **2016 + Volkswagen Amarok V6 Diesel**. It is recommended that the installation of the product be carried out by a competent qualified mechanic.

***Images are for reference purposes; actual product may differ.**

Important before starting

- Ensure the engine bay is clean and free from contaminants
- The filter head has direction arrows indicating the direction of flow
- You have the correct tools to complete the fitment
- Read the instructions in full and familiarize yourself with the installation before commencing any work

Included in the kit

- 1 x Fuel Manager Filter 2 Micron
- 1 x Bracket
- 1x 3m 10mm Fuel Hose
- 2x 1/4" NPT straight - 10mm
- 2x DP733-04 - 3/8" NPT plug
- 1x M8x25 Bolt
- 2x M8 Flat Washers
- 1x M8 Nyloc Nut
- 2x M6x16 Bolts
- 2x M6 Nyloc Nuts
- 4x M6 Flat Washers
- 4x hose Clamps 10mm
- 2 x push on 90 deg – 10mm
- 4x washers
- 1x hand primer kit
- 8 x 100mm Cable Ties
- 1x Engine Bay decal
- 1x Windscreen decal

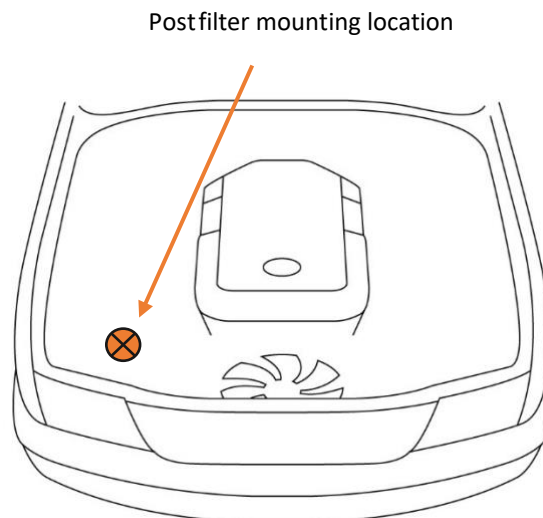

*Kit contents are subject to change based on component availability and/or refinement

Fuel Manager Post-Filter Normal Flow Header Connection

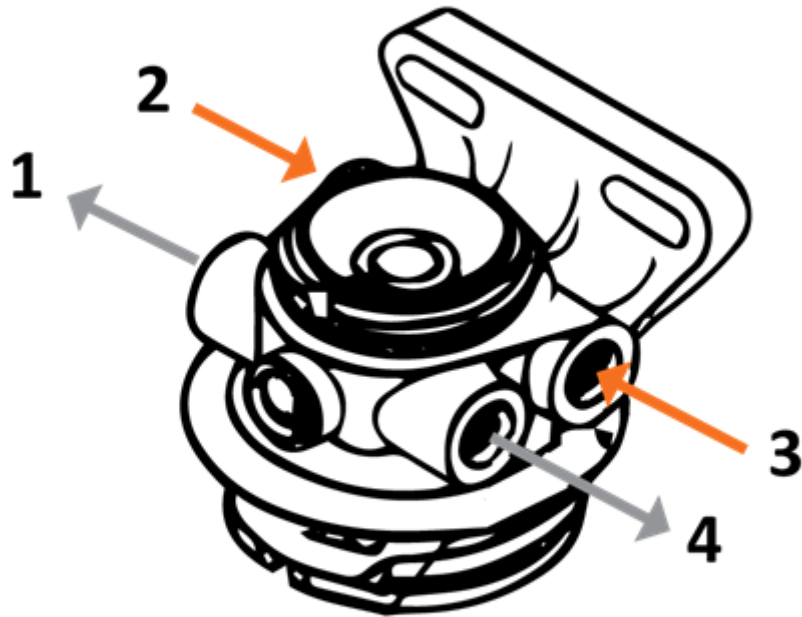

Ports 2 and 3 = INLET
Ports 1 and 4 = OUTLET

Installation Guide

1. Begin by removing the engine cover to give access to the area in the front driver's side behind the radiator.



Amarok V6 Engine Bay – Overall View

2. Remove the torx head screw holding down the driver's side corner of the plastic radiator cooling panel. Once removed, remove the M8 Bolt partially obscured by the panel. Replace the M8 Bolt with the new longer bolt in the kit, ensuring there is an M8 flat washer under the head of the bolt. Once in place and tightened the torx head screw can be reinstalled into the radiator cooling panel.

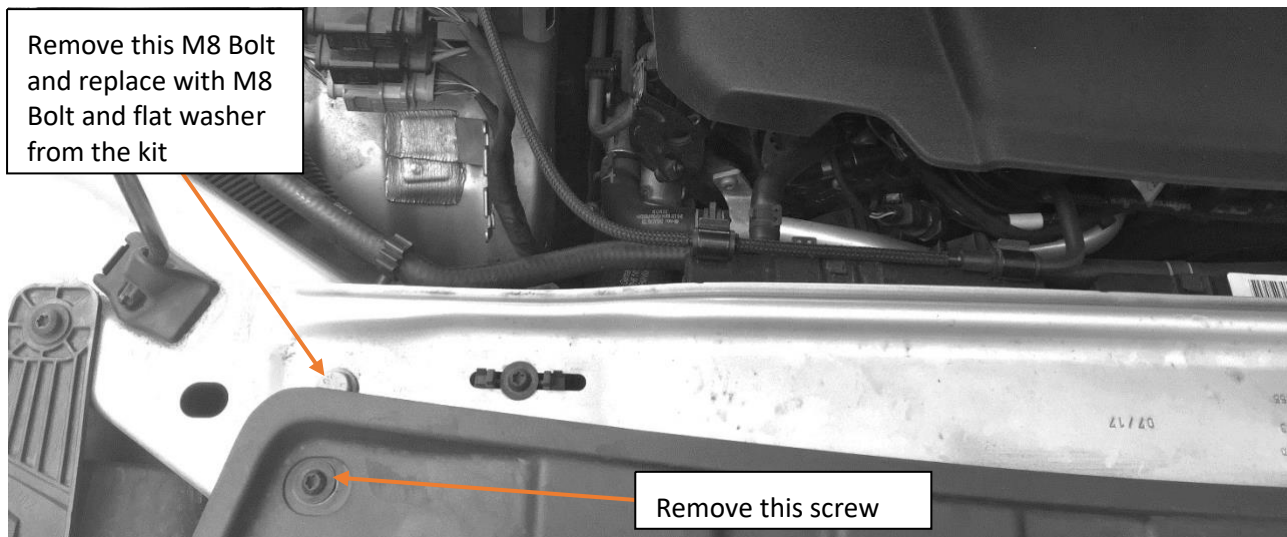

Detail of front Driver's side or radiator support panel

3. Install the main bracket to the underside of the radiator support panel, picking up the new longer bolt that was just installed. Use a flat washer and nyloc nut to secure in place. Do not fully tighten yet!
4. Install the second bracket to the body earth stud, making sure to sit the bracket on first, then the earth strap, then the factory dome nut. Use the M6x16 bolts, flat washers and nyloc nuts to secure the two brackets together it firmly in place.

5. Now you can tighten all the mounting bolts to secure the whole assembly in place.



Mounting Bracket installed in engine bay

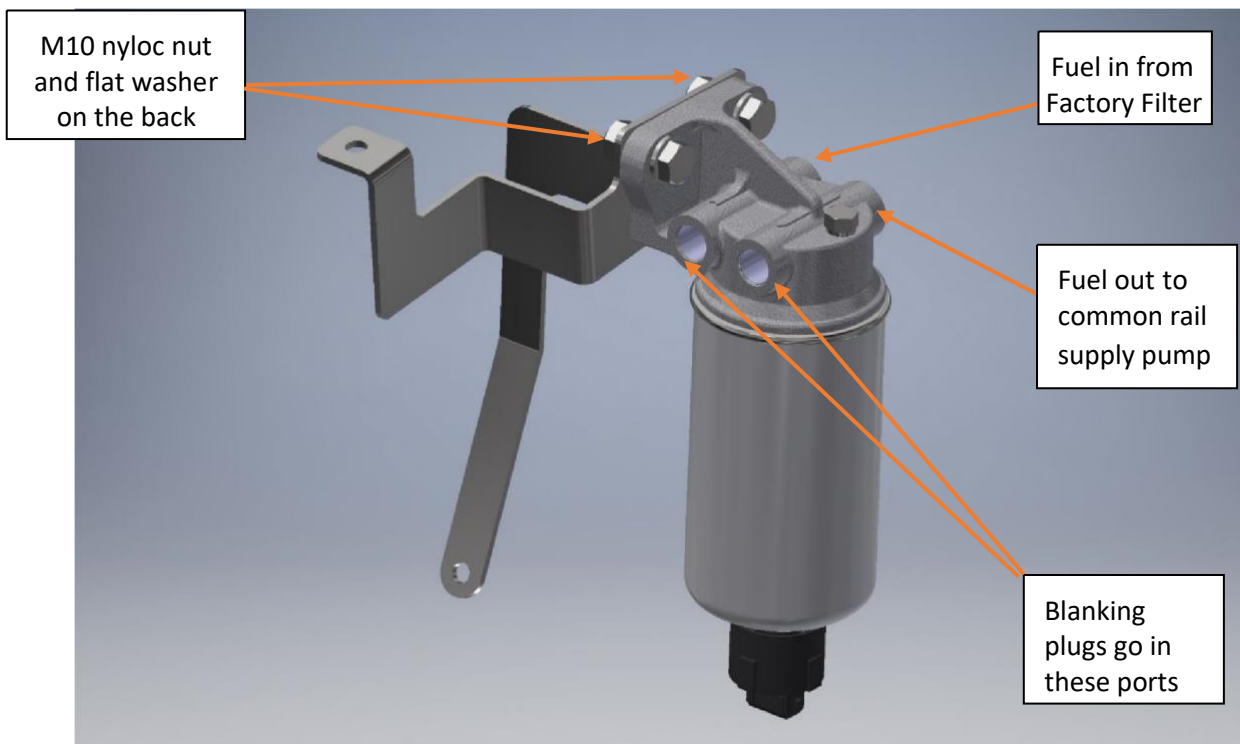

Pre-assembled Post-filter with bracket (Pre-line filter example shown. Fuel fittings not shown)



Note: It may be required to remove the pre-installed plugs and reinstall them based on the specific installation.

6. Install the M16 to -6 Adaptors to the ports on the Post-filter, they need to be on the same side as the engine. The blanking ports should be on the other side.
7. Bolt the fuel filter assembly into place, using the M10x30mm bolts and nyloc nuts, making sure to use a flat washer under each bolt head and nut. Adjust the position of the fuel filter assembly to make sure there is clearance from hoses and the wiring harness. Once you are happy with the location, tighten the bolts and nuts to retain in place.
8. Install two of the -6 to 10mm 90° push lock fittings to the -6 adaptors just installed. Face the fittings down, use Loctite to seal the threads and stop leaks.
9. Cut the supplied hose in half, push the hose supplied in the kit onto the inlet 10mm hose tail on the Post-filter assembly, when it is all the way on, secure with a clamp.
10. Connect inlet of Post Filter to outlet of Factory filter
11. Use the second length of fuel hose to connect the outlet port of Post-filter the and the inlet of the common rail supply pump
12. Bleed the system of air (on the Amarok a scan tool may be required). If additional bleeding is required (and after a filter change) there is a bleed screw on top of the Post-filter unit to remove air.
13. Once complete start the vehicle, carefully and toughly checking for leaks.
14. Run the vehicle for at least 20 minutes to ensure there are no air pockets in the fuel system.

End of Installation Guide