



Toyota Prado 150 1KD-FTV / 1GD-FTV Direction-Plus™ Post-Filter Kit Installation Guide

This document is to be used as a guide for the installation of the **Direction-Plus™ Fuel Manager™ FM100 Post-filter Kit (PF620DPK)** to a **Toyota Prado 150 1KD-FTV / 1GD-FTV**. It is recommended that the installation of the product be carried out by a competent qualified mechanic.

Important before starting

- Ensure the engine bay is clean and free from contaminants
- The fuel manager filter head has direction arrows indicating the direction of flow
- You have the correct tools to complete the fitment
- Read the instructions in full and familiarize yourself with the installation, before commencing any work

Kit contents

- 2x NPT STRAIGHT - 10MM
- 1x 2 BOLTS 2 NUTS 4 WASHERS
- 1x BRACKET - PRADO 150 FACE LIFT
- 2x DFL10 - FUEL LINE RUBBER (10MM)
- 2x DP733-04 - NPT PLUG
- 1x ELEMENT ASSEMBLY 2M
- 1x FM ENGINE BAY LABEL
- 2x HOSE CLAMP - 10MM
- 1x LOCTITE 567 THREAD SEALANT - 6ML
- 2X PUSH ON STRAIGHT - 10MM
- 1x WINDSCREEN LABEL

Post filter mounting location

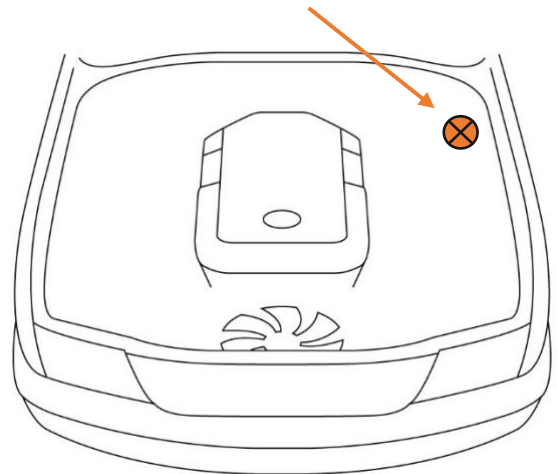

*Kit contents are subject to change based on component availability and/or refinement

Fuel Manager Post-Filter Normal Flow Header Connection

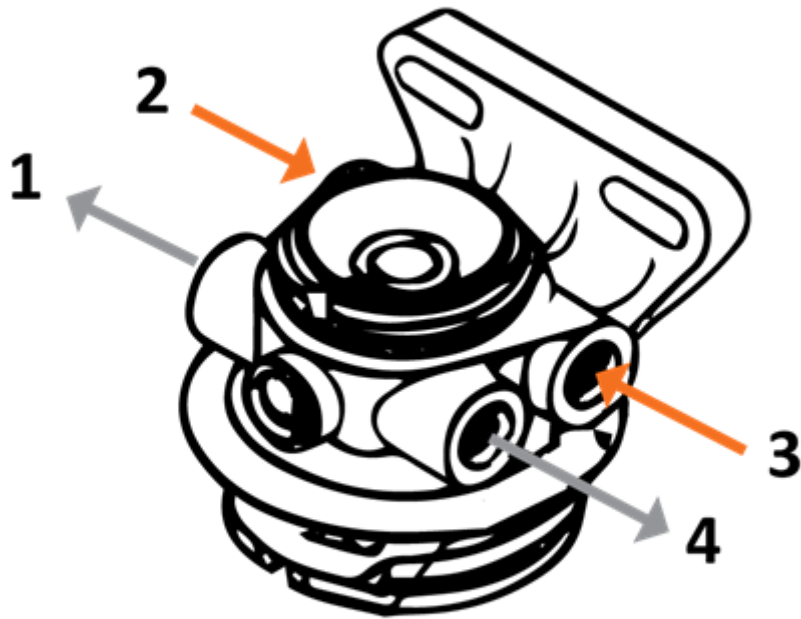

Ports 2 and 3 = INLET
Ports 1 and 4 = OUTLET



Installation Guide

1. Remove the two retaining nuts from the top of the factory filter housing
2. Place the Post-filter mounting bracket into its mounting location, sandwiched between the factory fuel filter and the factory fuel filter mounting bracket
3. With the supplied bolt, nut and washers, secure the base of the bracket ensuring that the large washer is installed on the underside of the guard
4. Install the NPT adaptors into the filter head ports that are facing towards the front of the vehicle using the supplied LOCTITE thread sealant.
5. Apply a small amount of LOCTITE thread sealant to the two black NPT plugs and install them into the two remaining ports in the Post-filter head.
6. Using the supplied 10mm bolts, washers and nuts, mount the FM100 Fuel Manager Post-filter assembly filter to the backside of the bracket
7. Measure from the outlet port of the factory filter to the inlet port of the fuel manager head (the arrows on the head indicate direction of flow) and cut to length a piece of the supplied 10mm hose
8. Lubricate the barbed end of one push-lock fitting and the inside portion of the hose to be fitted with a push-lock fitting with diesel fuel or WD40
9. Insert the barbed end of one push-lock fittings into the pre-lubricated end of the hose. Ensuring that the hose stops firmly against the inside of the bell cover.
10. With the assembled hose, screw the push-lock fitting on to the inlet port of the Post-filter. Connect the other end of the same hose to the outlet port of the factory filter and secure using a supplied 10mm hose clamp
11. Lubricate the barbed end of the remaining push-lock fitting and the inside portion of the remaining hose to be fitted with a push-lock fitting with diesel fuel or WD40
12. Insert the barbed end of the remaining push-lock fittings into the pre-lubricated end of the hose. Ensuring that the hose stops firmly against the inside of the bell cover.
13. With the now assembled hose, screw the push-lock fitting on to the outlet port of the Post-filter.
14. Measuring the hose in place between the outlet port of Post-filter to the inlet of the common rail supply pump and secure with a hose clamp
15. Connect the 10mm fuel hose to the inlet of the factory fuel filter and secure with a supplied 10mm hose clamp



16. Using the supplied nylon cable ties, secure any loose hose from rubbing on any other components
17. Bleed the fuel system by pumping the hand primer on the factory filter until firm
18. Start vehicle and run the vehicle, whilst checking all connections for leaks

END OF GUIDE